

Lug (Ring) Terminal

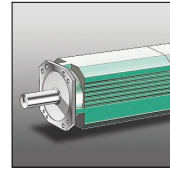

Lug (Ring) Terminal

J1 Standard Type

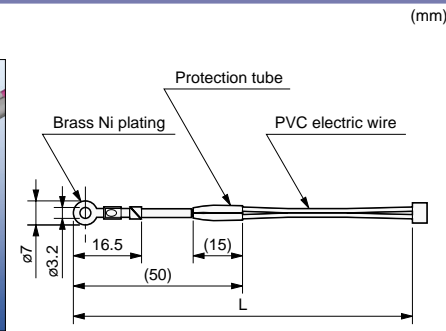
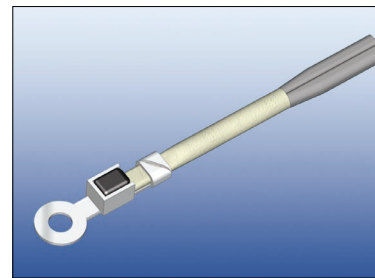

Features	Standard Lug terminal sensor with PSB type element. Designed for easy installation.
Applications	Magnetron, Data projector, Plotter, Inverter (multi-purpose & Automotive) and Heat pumps etc.
Operating temperature range	0°C to 150°C (sensing part)
Thermal time constant	Approx. 6 sec. (on hot plate)

J2 High Temperature Type

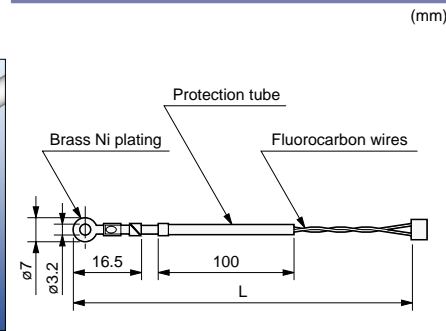
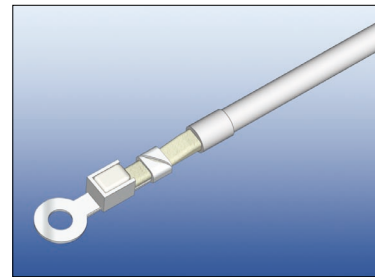

Features	Applicable for high temperature heaters with NS type element and heat proof sealing agent.
Applications	Heat blade cutter, Packing machine and Industrial Ironing machine etc.
Operating temperature range	-5°C to 300°C (sensing part)
Thermal time constant	Approx. 6 sec. (on hot plate)

J3 Compact Type

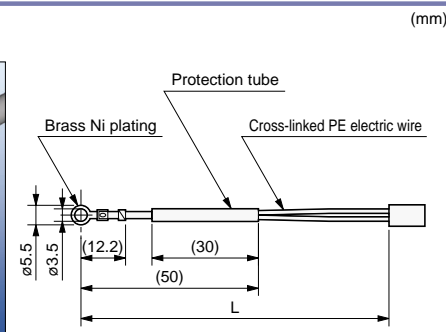
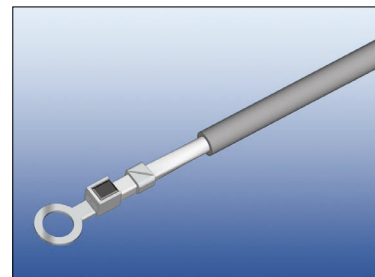

Features	PSB-S3 small element applied. Good for Fixing to narrow area.
Applications	Projector, Motor, Thermal head and Printers etc.
Operating temperature range	-5°C to 125°C
Thermal time constant	Approx. 3 sec. (on hot plate)

J4 for Heat Sink

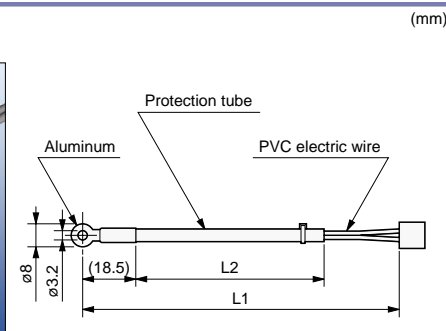
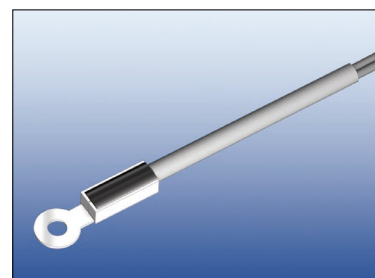

Features	Good for products with high volume production.
Applications	Heat sink for Inverters of Air conditioners etc.
Operating temperature range	0°C to 100°C
Thermal time constant	Less than 15 sec. (on hot plate)

※ Above-described shapes are just for example, customized designs are available.

BRAND



SD stands for Shibaura Denshi ("electronics" in Japanese).

It also means our activities.

- ① (production of) Sensing Device
- ② Successive Development
- ③ Speedy Delivery

ISO 9001 Approved

ISO 14001 Approved

