

# Air-Conditioning Equipment

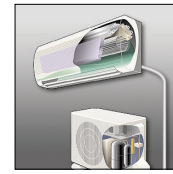

for air-Conditioning Equipment

## C1 for Room Temperature

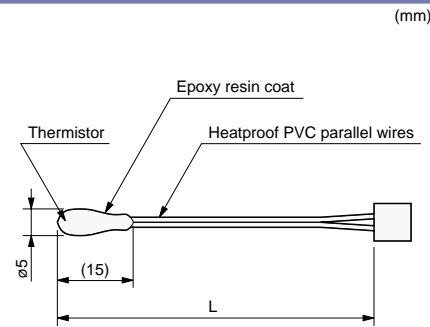
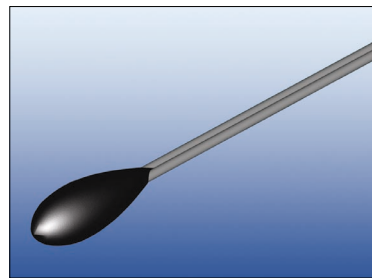

**Features**  
As both Chip and PSB type element are applicable, available for various temperature ranges. Epoxy coating around the element.

**Applications**  
Ambient temperature measurement etc.

**Operating temperature range**  
-25°C to 80°C

**Thermal time constant**  
Less than 5 sec. (in liquid)

## C2 for Room Temperature

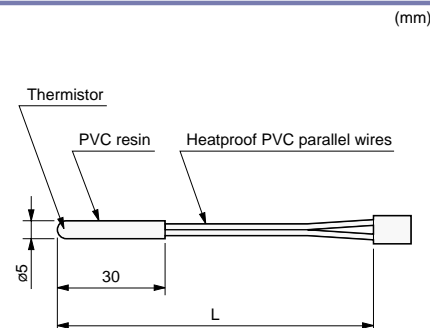
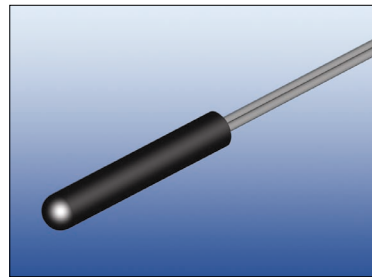

**Features**  
Highly drip-proof because PVC resin and PVC wires are integrated. Easy fixation with its flexibility.

**Applications**  
Ambient temperature measurement etc.

**Operating temperature range**  
-30°C to 100°C

**Thermal time constant**  
Less than 15 sec. (in liquid)

## C3 for Pipes (Chip Type Element)

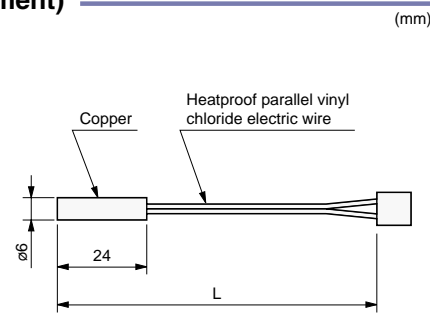
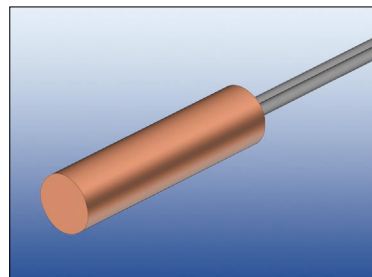

**Features**  
Both Chip and PSB type element are applicable. Epoxy coated element with protection cap. Good workability and durability. Double insulated lead wire for better weather resistance is also available.

**Applications**  
Pipe surface temperature etc.

**Operating temperature range**  
-30°C to 100°C

**Thermal time constant**  
Less than 10 sec. (in liquid)

## C4 for Pipes (Glass Type Element)

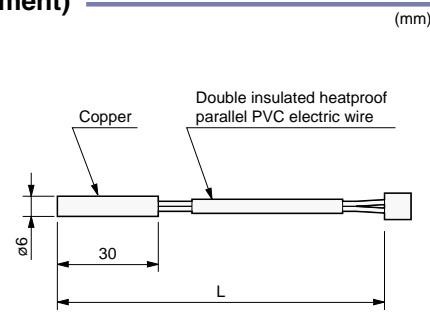
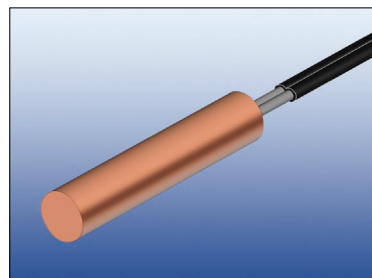

※ Above-described shapes are just for example, customized designs are available.

# Air Conditioning Equipment, Fire Prevention and Security Equipment



Air Conditioning Equipment

## C5 for Air Flow Sensor

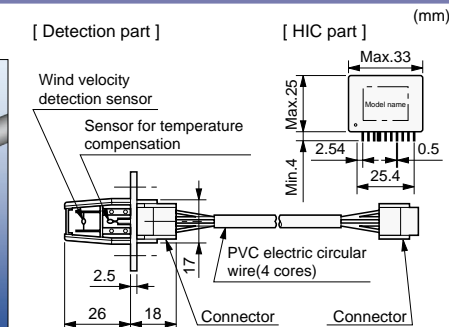
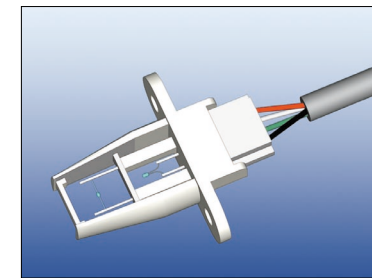

**Features**  
Consists of direct heated type PSB-A wind speed detection element and HIC circuit, it can easily detect wind speed. Alarm signals corresponding wind speed setting also can be supplied to the output.

**Applications**  
Filter clogging detection in clean bench etc.

**Operating wind speed range**  
0 to 20m/s (Normal pressure, normal air)

**Thermal time constant**  
Approx. 1 sec. (Normal pressure, normal air)

## for Fire Prevention and Security Equipment

### D1 for Fire Alarm

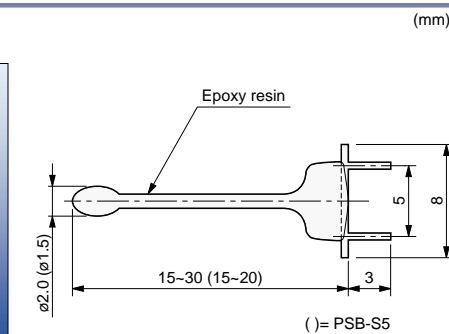
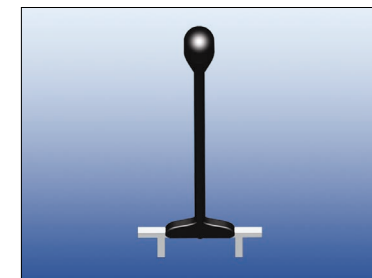

**Features**  
Epoxy dipping insulation. Directly mount on PCB. PSB-S3 and S5 are applicable.

**Applications**  
Fire alarm and PCB surrounding temperature detection etc.

**Operating temperature range**  
-30°C to 100°C

**Thermal time constant**  
PSB-S3 : 9~21 sec. (in air)  
PSB-S5 : 2~15 sec. (in air)

### D2 for Fire Alarm

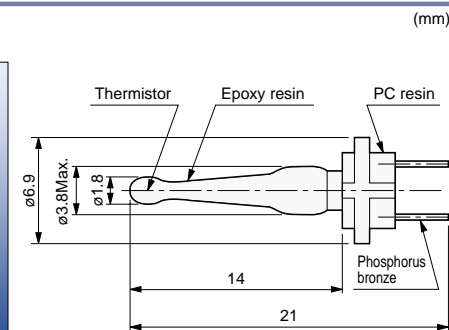
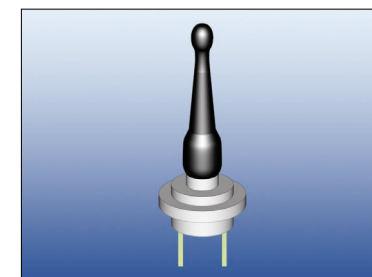

**Features**  
Epoxy dipping insulation. Commonly used for ceiling type fire alarm.

**Applications**  
Fire alarm and PCB surrounding temperature detection etc.

**Operating temperature range**  
-40°C to 120°C

**Thermal time constant**  
14~24 sec. (in air)

### D3 Duct Fire Prevention

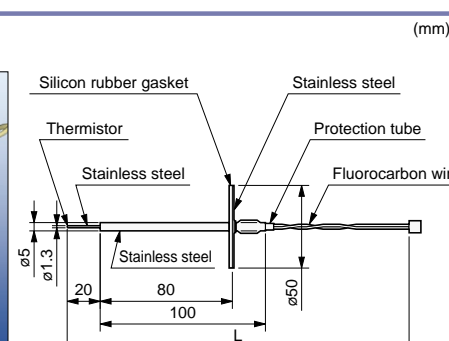
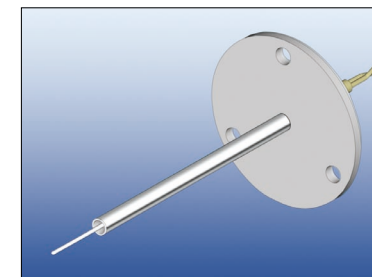

**Features**  
Quick response and durable sensor for fire prevention using PSB-S5 element.

**Applications**  
Extinguish equipment for professional kitchen etc.

**Operating temperature range**  
-40°C to 200°C

**Thermal time constant**  
Less than 3 sec. (in air)

※ Above-described shapes are just for example, customized designs are available.